

1 UNIT 304  
SCALE: 1/4" = 1'-0"

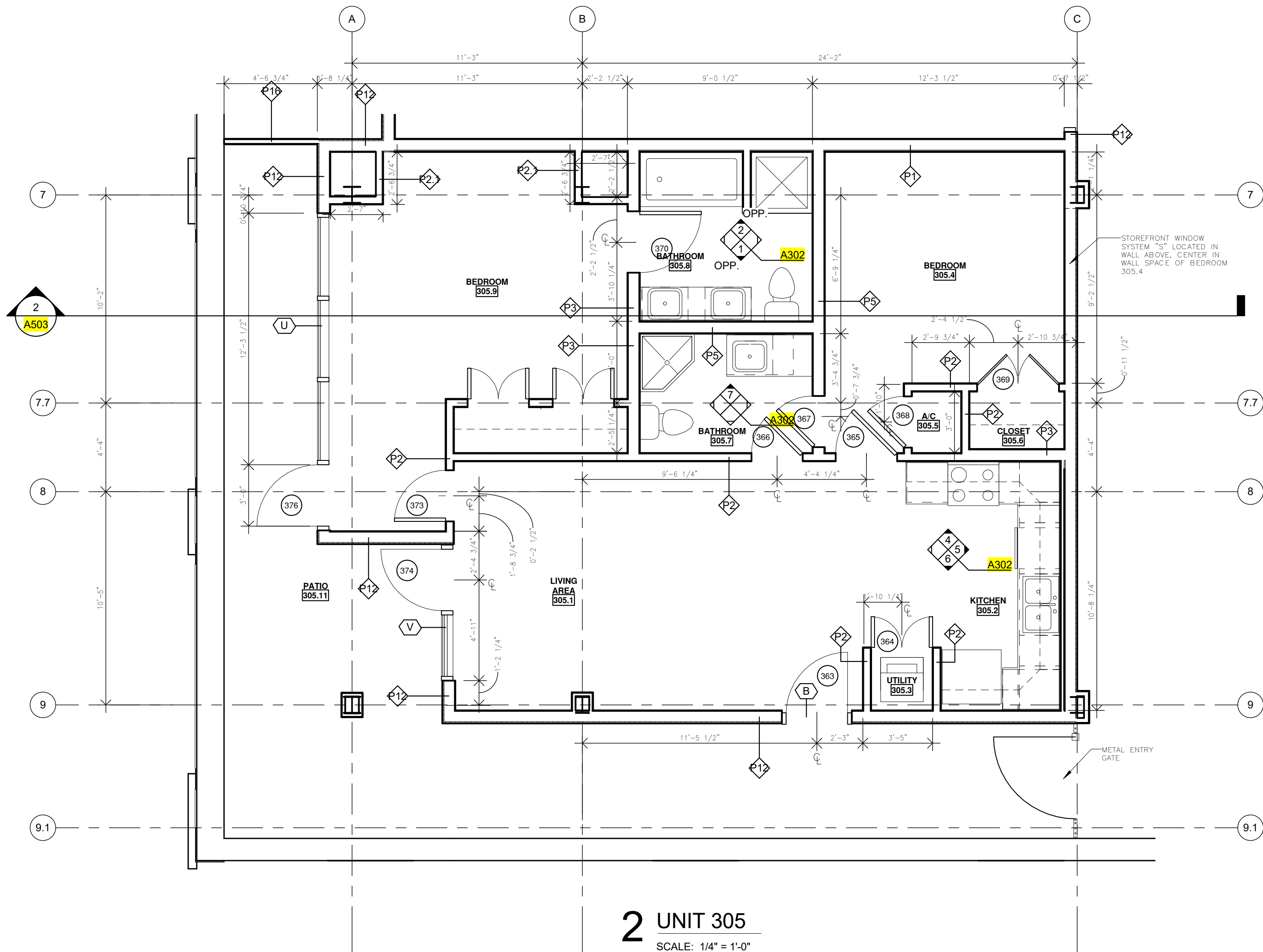

2 UNIT 305  
SCALE: 1/4" = 1'-0"

WAX MUSEUM CONDOS  
917 CONTI STREET  
NEW ORLEANS, LA.

THESE PLANS AND SPECIFICATIONS HAVE BEEN PREPARED BY ME OR UNDER MY CLOSE PERSONAL SUPERVISION AND TO THE BEST OF MY KNOWLEDGE AND BELIEF THEY COMPLY WITH ALL CITY, STATE AND FEDERAL REQUIREMENTS, AND I AM NOT PROVIDING CONTRACT ADMINISTRATION.

CERTIFIED CORRECT

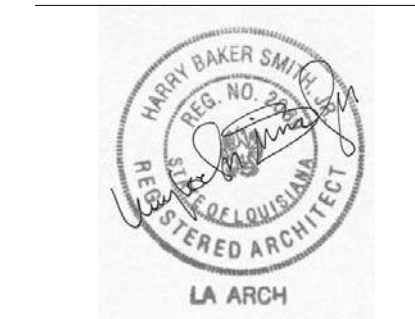

THIS DRAWING IS CONFIDENTIAL AND NOT BE LOANED, REPRODUCED, COPIED, EITHER WHOLLY OR IN PART, OR MADE PUBLIC IN ANY MANNER WITHOUT THE WRITTEN CONSENT OF HBSA II ARCHITECTS. A PROFESSIONAL L.L.C. ALL RIGHTS OF DESIGN OR INVENTION ARE RESERVED AND WILL REMAIN THE SOLE PROPERTY OF HBSA II ARCHITECTS A PROFESSIONAL L.L.C.

| REVISION HISTORY |          |                    |    |       |
|------------------|----------|--------------------|----|-------|
|                  | DATE     | DESCRIPTION        | BY | APP'D |
| 1                | 06/20/16 | SCHEMATIC DESIGN   |    |       |
| 2                | 07/14/16 | DESIGN DEVELOPMENT |    |       |
| 3                | 08/19/16 | FOUNDATION PERMIT  |    |       |
| 4                | 09/30/16 | VCC PERMIT REVIEW  |    |       |

ENLARGED UNIT PLANS

PROJECT#: 1435  
PHASE: PERMIT  
DRAFTER: Author  
CHECKER: Checker  
SCALE: AS NOTED  
ISSUED: 09/30/2016  
SHEET#:

A116